

Doon Sink 120x60cm LH Drainer, No Taphole

ILLUSTRATED

- S1273** (ST A) Doon sink, single bowl left hand drainer 120 x 60cm, no tapholes, no overflow
- S8270** (TB H1) Markwik ½" lever action bib taps
- B1686** Nimbus 21 concealed bib tap wall mount with self centralising installation (pair)
- B1682** Nimbus 21 1/2" x 75mm bib tap extensions (pair)
- S8760** Waste 1½" unslotted strainer waste, 50mm long, 75mm dia. brass
- S8925** (TRR2/P) Trap 1½" plastic resealing bottle with 75mm seal, multi-purpose outlet

OPTIONS

- S9281** Leg 900mm stainless steel to floor (2 required)
- B1673** Nimbus 21 1/2" bib taps with anti-vandal outlet (pair)
- S8915** Trap 1½" plastic bottle with 75mm seal, multi-purpose outlet

ILLUSTRATED PRODUCT DETAILS





Weights

- S1273** 11.00 KG
- S8270** 1.65 KG
- S8760** 0.23 KG
- S8925** 0.33 KG

Materials

- S1273** Stainless Steel
- S8270** Chrome Plated Brass
- B1686** Chrome Plated Brass
- B1682** Chrome Plated Brass
- S8760** Chrome Plated Metal
- S8925** Plastic

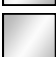
Finishes

- S1273**  Stainless Steel finish (MY)
- S8270**  Chrome (AA)
- B1686**  Chrome (AA)
- B1682**  Chrome (AA)
- S8760**  Chrome (AA)
- S8925**  Neutral / No Finish (67)

Standards

Stainless steel sheet to BS EN 10088: Part 2: 2005. Conforms to Metal sinks BS EN 13310. NHS specification HBN 00-10.

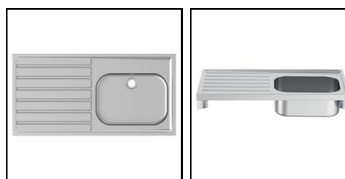
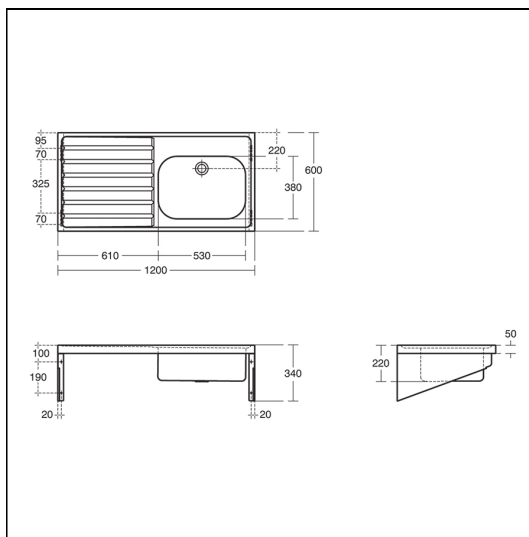

FEATURES

