

Kinloch Trough Urinal, 180cm Top Inlet, Centre Outlet

ILLUSTRATED

S1288 Kinloch urinal 180cm long complete with 2" domed strainer waste, centre outlet, complete with flushpipes and autocistern

OPTIONS

S1309 Kinloch urinal corner plinth, stainless steel
S1310 Kinloch urinal cover strip to join separate urinals

ILLUSTRATED PRODUCT DETAILS

Sizes

S1288 L:1800

Finishes

S1288  Stainless Steel (MY)

Weights

S1288 24.00 KG

Materials

S1288 Stainless Steel

Standards

Manufactured from 1.5mm Stainless Steel 1.4301 (304) to BS EN 10088: part 2: 2005. NHS specification HBN 00-10. EN 13407.

Special Notes

Kinloch urinal complete with central domed strainer waste 2in BSP outlet. Knock out inlet position allows pipework to be exposed or concealed. Urinals on 2 or more walls can be joined using S1310MY stainless steel cover strip and S1309MY stainless steel corner plinth.

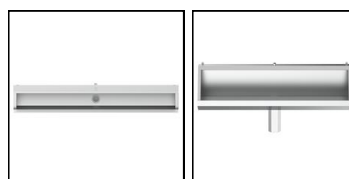
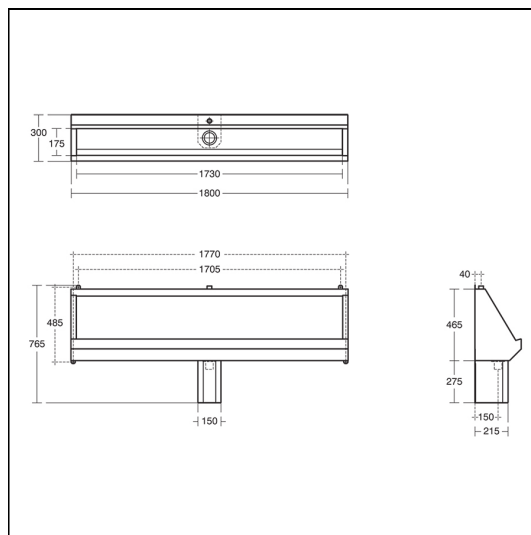

FEATURES

