

i.life A 104cm Vanity Washbasin

ILLUSTRATED

- T4621** i.life A 104cm vanity washbasin, 1 taphole
- E0157** Wall fixing set
- BD246** Ceraplan single lever basin mixer, with click waste
- E0079** Trap 1¼" Contemporary metal bottle, 75mm seal

OPTIONS

- EE230339** Space saving trap and waste pipe assembly for use with furniture basin units
- T5257** i.life A 100cm wall hung vanity unit with 2 drawers, (separate handles required)
- R0265** Eurovit+ 100cm wall mounted vanity unit with drawers
- E0821** Connect Air 100cm wall hung vanity unit with 2 drawers
- E0828** Connect Air 100cm wall hung vanity unit with 1 drawer and open shelf
- T5326** i.life 34cm handle

ILLUSTRATED PRODUCT DETAILS

Sizes

T4621 w:1040 x d:460

Weights

T4621 28.40 KG

E0157 0.16 KG

BD246 1.77 KG

E0079 1.45 KG

Materials

T4621 Fine Fireclay

E0157 Metal

BD246 Chrome Plated Brass

E0079 Chrome Plated Metal

Finishes

T4621  White (01)

E0157  Neutral / No Finish (67)

BD246  Chrome (AA)

E0079  Chrome (AA)

Capacity

T4621 9.1 litres

Flow rates

BD246 5 Litres per minute @ 3 bar pressure

Designer

Palomba Serafini Associati

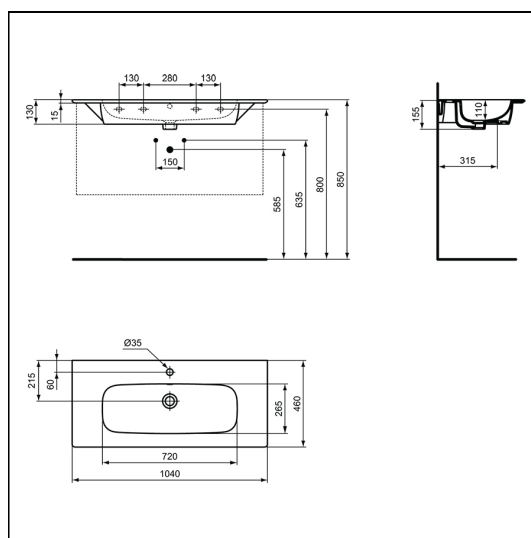

Standards

Washbasin to BS EN 14688 and BS EN 31

Special Notes

Washbasin wall mounted using E0157 wall fixing set or supplied on dedicated furniture units. When fitted to furniture washbasin must be secured with the E0157 fixing set.