

i.life 170cm x 80cm Rectangular Idealform Bath

ILLUSTRATED

- T4774** i.life 170cm x 80cm rectangular idealform bath with no taphole
- BD264** Ceraplan dual control bath filler
- E3194** Unilux 170cm front panel
- E4833** Unilux Plus+ 80cm end panel
- S8970** Trap 1½" plastic P with 75mm seal, multi-purpose outlet suitable for plastic and BS copper pipe
- E1486** Luxury bath pop-up waste and overflow
- A5901** TMV thermostatic mixing valve, 22mm

OPTIONS

- T4828** i.life Fixation Set



ILLUSTRATED PRODUCT DETAILS







Weights

- T4774** 22.00 KG
- BD264** 2.39 KG
- E3194** 3.65 KG
- E4833** 2.00 KG
- S8970** 1.00 KG
- A5901** 0.60 KG

Materials

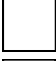
- T4774** Acrylic
- BD264** Chrome Plated Brass
- E3194** High Impact Polystyrene
- E4833** High Impact Polystyrene
- S8970** Plastic
- E1486** Mixed Material
- A5901** Chrome Plated Metal

Finishes

- T4774**  White (01)
- BD264**  Chrome (AA)
- E3194**  White (01)
- E4833**  White (01)
- S8970**  Neutral / No Finish (67)
- E1486**  Chrome (AA)
- A5901**  Chrome (AA)

Capacity

- T4774** 211.0 litres (to overflow)

Designer

Palomba Serafini Associati

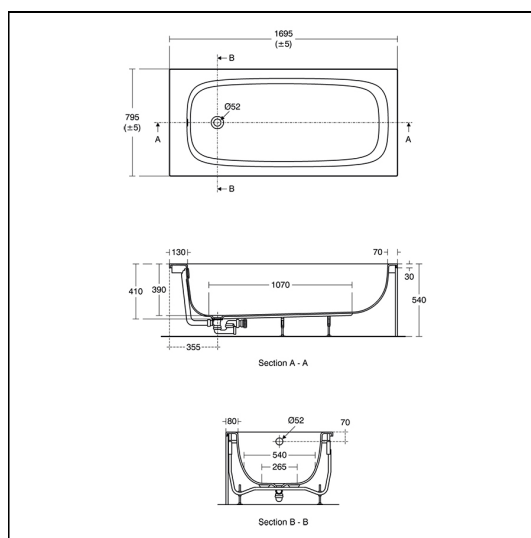

FINISH OPTIONS



Standards

EN 198:2008. EN 14516